

ITEM NO.	PART NUMBER	DESCRIPTION	QTY.
1	11601065	DRUM ASSEMBLY	1
2	01200161	SHOE	2
3	01000038	SPRING (WHITE)	2
4	01900076	RETAINING RING	1
5	11301011	HUB ASSEMBLY	1

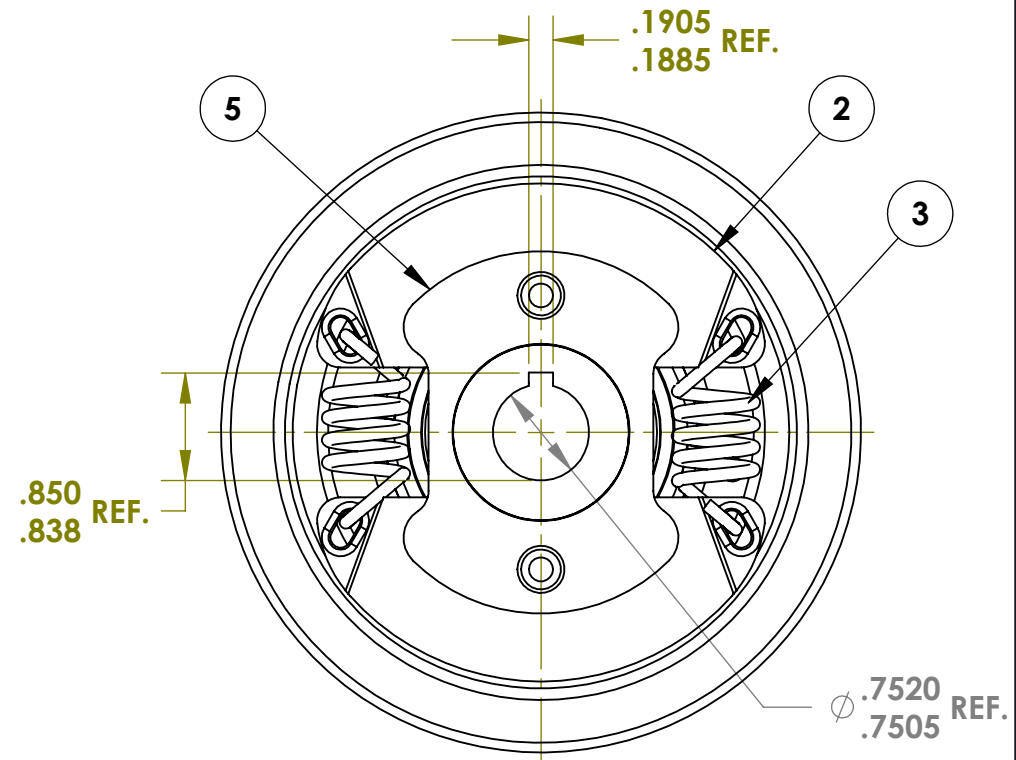
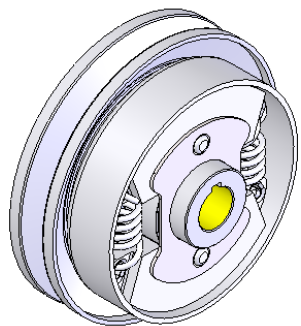
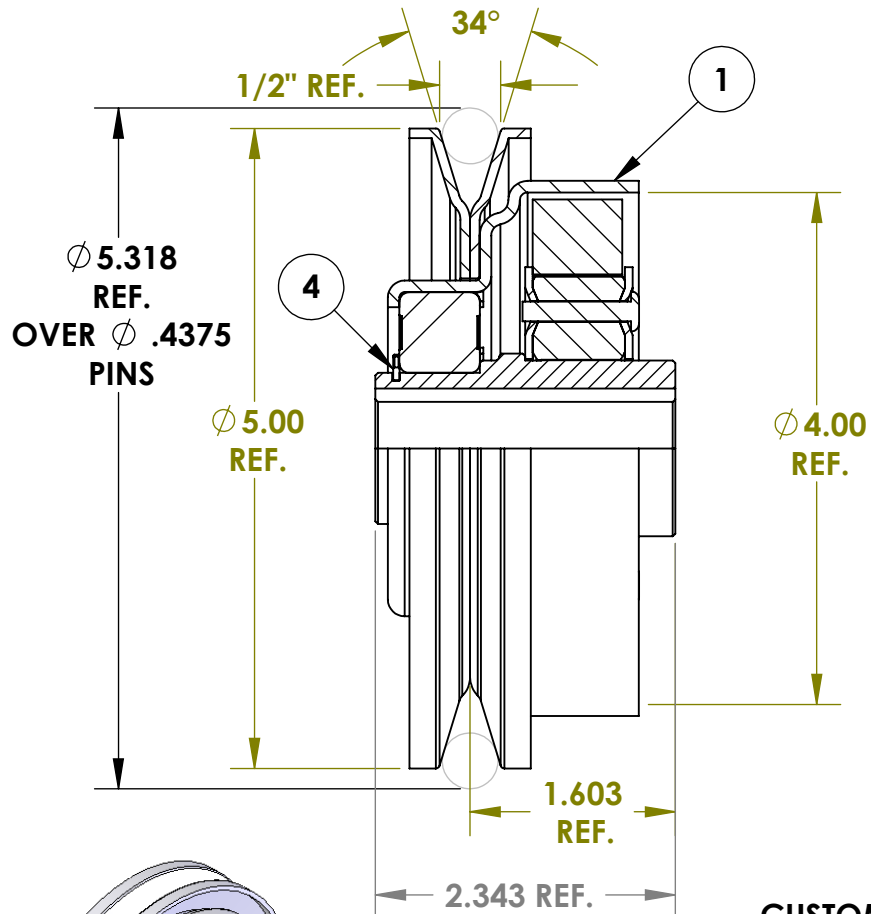

CUSTOMER: BROADBENT

PULLEY Ø 5.00 "A" GROOVE

ENGAGEMENT 2300 R.P.M.

MOUNTING OUTBOARD

SETTING STRAIGHT

DRAWN DATE 12/03/07

CHECKED DATE 3/28/08

PROPERTY OF NORAM FOR
CONFIDENTIAL USE ONLY.

TOLERANCES UNLESS
OTHERWISE SPECIFIED

XX ± .010
XXX ± .005
XXXX ± .003
FRAC. ± 1/64
ANGLE ± 1°

REMOVE ALL BURRS

SCALE 1:1.5

DRW. BY MJG

CHK'D BY SMY

PROJECT NUMBER



NORAMTM
Power Transfer Solutions

PART CLUTCH

MATERIAL

SURFACE FINISH 125 UNLESS SPECIFIED

PART NO.
4000T027

H	12/03/07	REDRAWN IN SOLIDWORKS
REV	DATE	DESCRIPTION